



FOR SALE

LAKWOOD LAKESIDE LIVING

Welcome to lakeside living in a quiet residential cabin park. This is a land lease over 55's community, with access to a fishing jetty, peaceful reserve & a lakeside walking track. Future park plans include a new BBQ area & playground. It's a comfortable 800m stroll to the local Lakewood shops containing Woolworths, a medical centre, pharmacy, pathology, cafes, beauty salon, butcher, liquor shop & other specialty shops. Also only a few minutes drive to the CBD of Laurieton.

Currently we have for sale;

- * 4 x new 1 bedroom cabins at \$275,000 each, all with reverse cycle air conditioning, gas cooktop/oven & parking space (sites 33,34,35,37).
- * 1 x new 2 bedroom cabin for \$298,000 with reverse cycle air conditioning, gas cooktop/oven & parking space (site 58).
- * 5 x new 2 bedroom cabins on order to arrive approx. late June priced between \$298,000 - \$315,000 some with lake views & extra large sites (site 57 is \$298,000, sites 56,41,39,38 are \$315,000). Choice of 2 plans.
- * Weekly site fees are \$172, with electricity & water separately metered.

Disclaimer: While every effort has been made to ensure the accuracy of these particulars, no warranty is given by the vendor or the agent as to their accuracy. Interested parties should not rely on these particulars as representations of fact but must satisfy themselves by inspection or otherwise. Although high standards have been used in preparing this document, no legal responsibility can be accepted for any loss or damage resulting from the content or use of this information. Any photographs show only certain parts of the property as they appeared when taken. Areas, amounts, measurements, distances, and all other numerical information are approximate only. Note: Every care has been taken to verify the accuracy of the details in this advertisement; however, we cannot guarantee its correctness. Prospective purchasers are requested to take necessary action to satisfy themselves with any pertinent matters.

2 BED | 1 BATH | 1 CAR

PRICE:
\$275,000 - \$298,000

OPEN FOR INSPECTION:
May 28 at 2:00pm - 3:30pm



Chris Gill
0438866000
chris.gill@atrealty.com.au
www.atrealty.com.au

LAURIETON RESIDENTIAL PARK

1062A Model

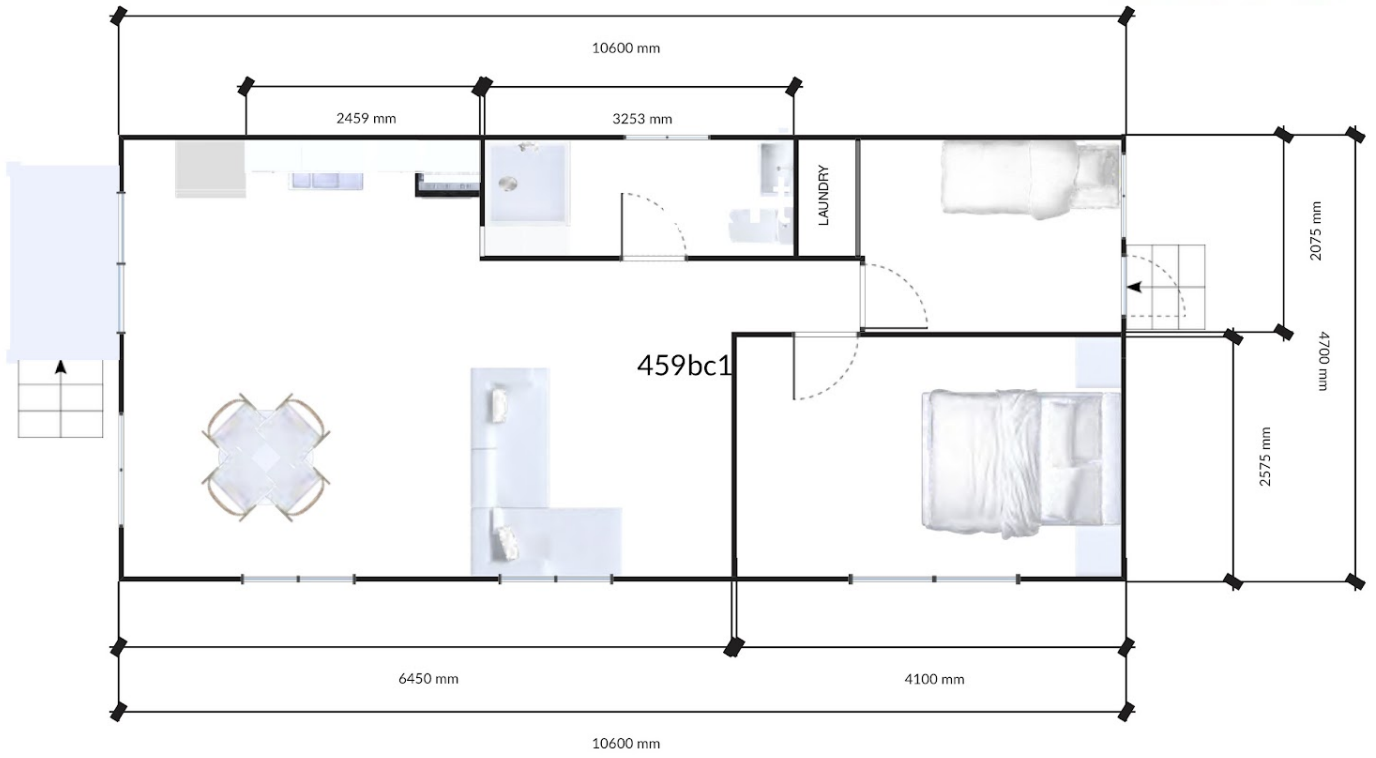

Disclaimer: Please note this floor plan is for marketing purposes and is to be used as a guide only. All dimensions are estimates only and may not be exact measurements.