

ADDRESS UPON REQUEST



FOR SALE

EXCEPTIONAL VALUE - CHELSEA APARTMENTS - FANTASTIC ONE BEDROOM APARTMENT IN QUIET LOCALE

“The Chelsea” represents the perfect investment or inner-city retreat for young professionals. This spacious one-bedroom apartment with study nook features contemporary design combined with resort style living and is well-positioned in the emerging Bowen Hills precinct. Offering plenty of light with floor to ceiling windows and a spacious floorplan, this residence is perfect for entertaining. With its modern kitchen, complete with stone benchtops and stainless-steel appliances, it flows with ease into the living area and onto the enclosed all weather balcony. This indoor/outdoor area is cleverly designed and features bi-fold glass windows providing all weather protection to enjoy this space at any time.

The functional layout features one bedroom and one bathroom plus a study area for students or working from home. Glass sliding doors draw soft natural light into the open-plan kitchen and living zone and also provide direct access to the covered entertainer’s patio.

The contemporary finishes and fixtures throughout ensure a fantastic rental income. This building is ideally located close to public transport, busy shops and a range of dining options and you’re also close to the Royal Brisbane and Women’s Hospital.

Features include:

- Perfect set-and-forget investment with the potential for future growth
- No car space – No car needed here – walk to everything
- Storage space
- Spacious one bedroom featuring built-in robe
- Study nook
- Modern Kitchen with spacious open floorplan
- All-weather enclosed balcony
- Ducted air conditioning and ceiling fans throughout

1 BED | 1 BATH | 0 CAR

PRICE:
Contact Agent

OPEN FOR INSPECTION:
N/A



Frontline Properties
0452426095
fpa@atrealty.com.au
www.atrealty.com.au

TYPE A16

One bedroom
One bathroom
Study nook
Fully equipped kitchen
Alfresco balcony with sliding doors and bi-fold windows
Fully ducted airconditioning

Internal area 46.0m²

Alfresco 9.8m²

Total area 55.8m²

Note 1: Ability for conversion to accessible apartment.

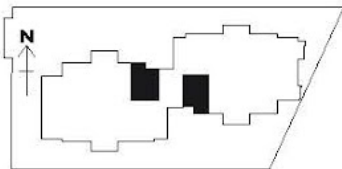

Disclaimer: Please note this floor plan is for marketing purposes and is to be used as a guide only. All dimensions are estimates only and may not be exact measurements.