

FOR SALE

AFFORDABLE & RELAXED NUNDAH LIFESTYLE

Proudly presented by local agent Mark Roemermann ...

- * Private, fresh and inviting
- * Fabulous full-size entertainment deck
- * Flowing indoor/outdoor living spaces
- * Modernised kitchen and bathroom
- * Polished hardwood floors
- * Easy care, child or pet-friendly yard
- * High-speed NBN connectivity
- * Cafes, restaurants, boutique shopping just a short stroll away
- * Close to transport and Toombul shopping and cinemas

What a location, public transport at your doorstep, easy access to the Brisbane CBD, Brisbane Airport, both coasts, parks, cafes, great schools and Nundah Village.

This immaculately presented three bedroom home offers the best of easy care living. Positioned on a level 417m block, all the works done. With a wonderfully functional galley style kitchen, inviting lounge and dining exuding warmth with a breath of fresh air. A cleverly designed private front deck provides ambient light and a cosy retreat off the main living area. The contemporary colour scheme throughout and glistening hardwood floors add to the modern feel of the home.

The master bedroom comes complete with large walk-in robe, fully carpeted and access to the rear deck and a pretty garden vista. There's a further two generous bedrooms, one with built-ins all essential for family and guests. A modern, monochromatic-themed fully tiled bathroom with double shower and separate toilet complete the picture.

We've saved the best for last! Let the outdoors in, a massive, newly constructed, covered entertaining deck that overlooks the level, fully fenced garden perfect for family and friends. Whether it's party central or just relaxing and soaking up the garden's serenity, you'll love it.

The property also boasts a brand new laundry, split air-conditioning and single lock up garage, plus extra off street parking.

Move in and enjoy, major centres at your doorstep, this property is ideal for young families,

3 BED | 1 BATH | 1 CAR

PRICE:
For Sale

OPEN FOR INSPECTION:
N/A



Mark Roemermann

0413877230

markroemermann@atrealty.com.au

www.atrealty.com.au

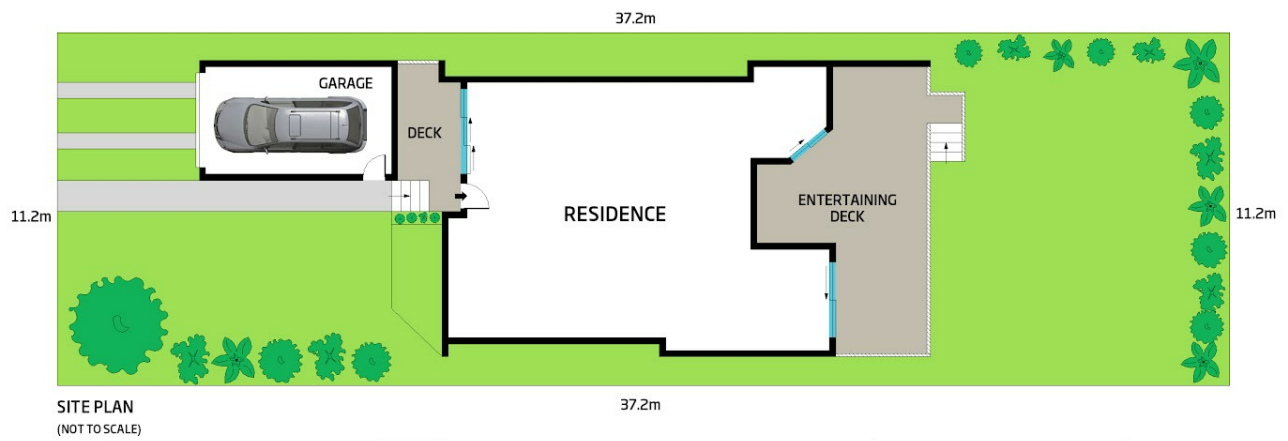

116 YORK STREET, NUNDAH

Plan is indicative of layout only and not to scale. All room sizes and dimensions shown on this plan including but not limited to doors, windows and cabinets are approximate. No responsibility is taken for errors contained in this document and all information provided should not be relied upon. Plan by Digital Real Estate: www.digitalrealestate.com.au



Disclaimer: Please note this floor plan is for marketing purposes and is to be used as a guide only. All dimensions are estimates only and may not be exact measurements.