

ADDRESS UPON REQUEST



FOR SALE

MODERN 3BR TOWNHOUSE IN GROWING NARANGBA - VACANT OCCUPANCY

This modern three-bedroom townhouse offers a practical three-level design and low-maintenance living in a convenient Narangba location. Positioned on a 178m² allotment, the property is well suited to families, first-home buyers, and investors seeking a functional home close to everyday amenities.

On the ground floor, the home features a single remote garage with internal access, a dedicated laundry area, and an additional living space that can be used as a media room, home office, or study. This flexible area opens to a private courtyard, providing extra space for work, relaxation, or entertaining.

The first floor is the main living level and includes an open-plan kitchen, dining, and living area designed for everyday comfort. This level also features a balcony and a convenient powder room for guests.

On the second floor, there are three bedrooms with built-in wardrobes, including the master bedroom with its own ensuite. A central bathroom services the remaining two bedrooms.

Located within walking distance to local shops and Narangba railway station, the property offers easy access to direct rail services to Brisbane and the Sunshine Coast. It is also close to schools, childcare centres, parks, and sporting facilities, with convenient access to the Bruce Highway and the shopping and dining precincts of North Lakes.

Combining a flexible floor plan, multiple living areas, and a highly convenient location, this well-presented townhouse offers an excellent opportunity to secure a quality home or investment in the growing Narangba community.

3 BED | 2 BATH | 1 CAR

PRICE:
For Sale

OPEN FOR INSPECTION:
N/A



Frontline Properties
0452426095
fpa@atrealty.com.au
www.atrealty.com.au

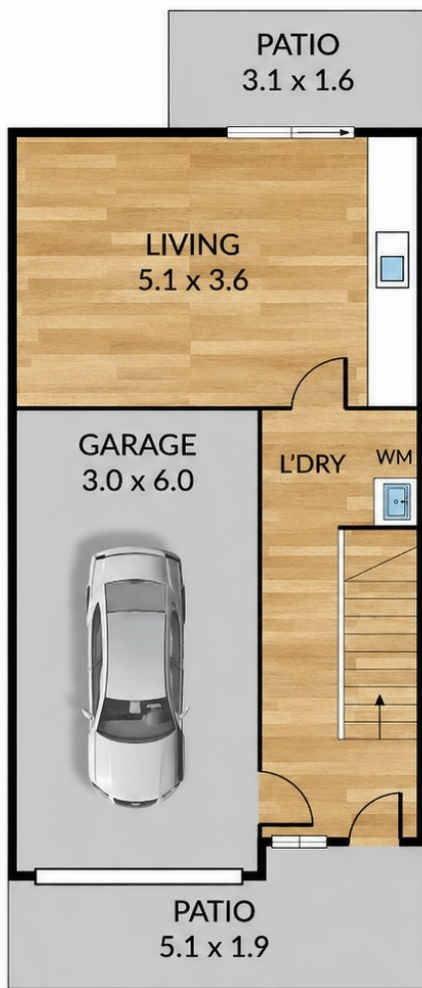

GROUND FLOOR

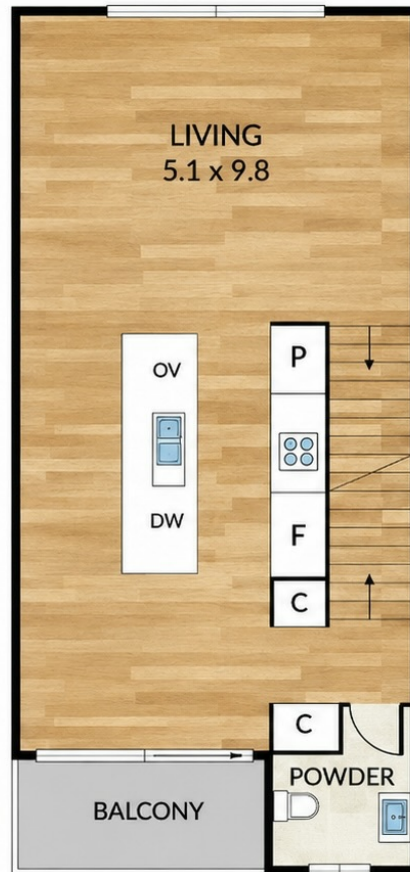

FIRST FLOOR

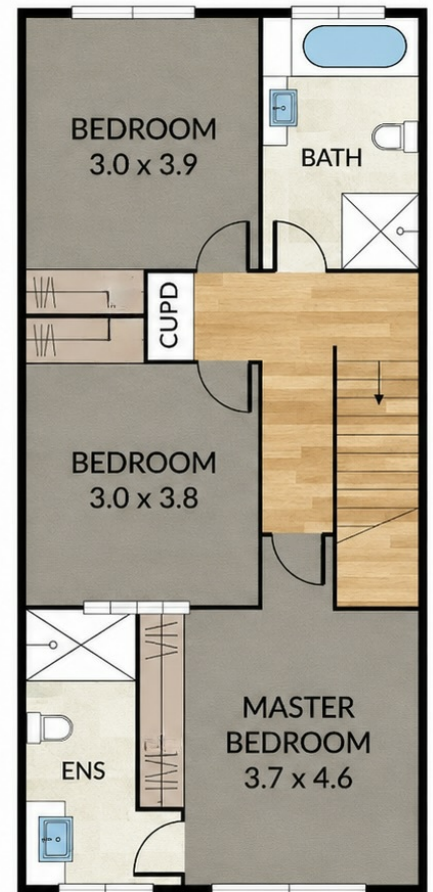

SECOND FLOOR

Disclaimer: Please note this floor plan is for marketing purposes and is to be used as a guide only. All dimensions are estimates only and may not be exact measurements.