



FOR SALE

SPACIOUS ANNANDALE ESTATE

This magnificent four-bedroom family haven at 10 Wave Hill Drive showcases the very best of contemporary living in one of Townsville's most prestigious suburbs. Nestled on a generous 947 square metre block in sought-after Annandale, this impressive residence offers 347 square metres of thoughtfully designed living space that seamlessly blends indoor comfort with spectacular outdoor entertaining.

The heart of this home features four spacious bedrooms including a master suite with ensuite, complemented by a well-appointed bathroom that serves the needs of busy family life with added powder room. Built-in wardrobes throughout provide abundant storage, while air conditioning ensures year-round comfort in North Queensland's tropical climate. The thoughtfully planned layout includes a dedicated lounge area perfect for family gatherings and quiet relaxation.

Step outside to discover your own private resort-style paradise featuring an inviting in-ground swimming pool that becomes the centerpiece of an extraordinary outdoor entertainment precinct. The expansive entertainment area creates the perfect backdrop for hosting friends and family, while the fully fenced property ensures privacy and security for children and pets alike.

Practical features abound with a remote-controlled double garage providing secure parking for two vehicles, plus additional secure parking options and handy storage sheds. The dishwasher-equipped kitchen makes meal preparation and cleanup effortless, while the outdoor entertainment areas extend your living space into the beautiful Queensland sunshine.

- Four generous bedrooms with built-in wardrobes
- Large bathroom and powder room including master ensuite
- In-ground swimming pool with impressive entertainment area
- Double remote garage plus additional secure parking
- Air conditioning and dishwasher included

Annandale represents the pinnacle of family-friendly suburban living, known as one of Townsville's most desirable addresses where many of the city's successful residents choose to call home. This master-planned community offers an exceptional lifestyle with the stunning Ross River forming the northern boundary and creating beautiful wetlands that provide a natural sanctuary right on your doorstep.

4 BED | 2 BATH | 2 CAR

PRICE:

Offers over \$1,000,000

OPEN FOR INSPECTION:

May 24 at 1:00pm - 1:30pm



Ken Entriken

0419689498

kenentriken@atrealty.com.au

www.atrealty.com.au

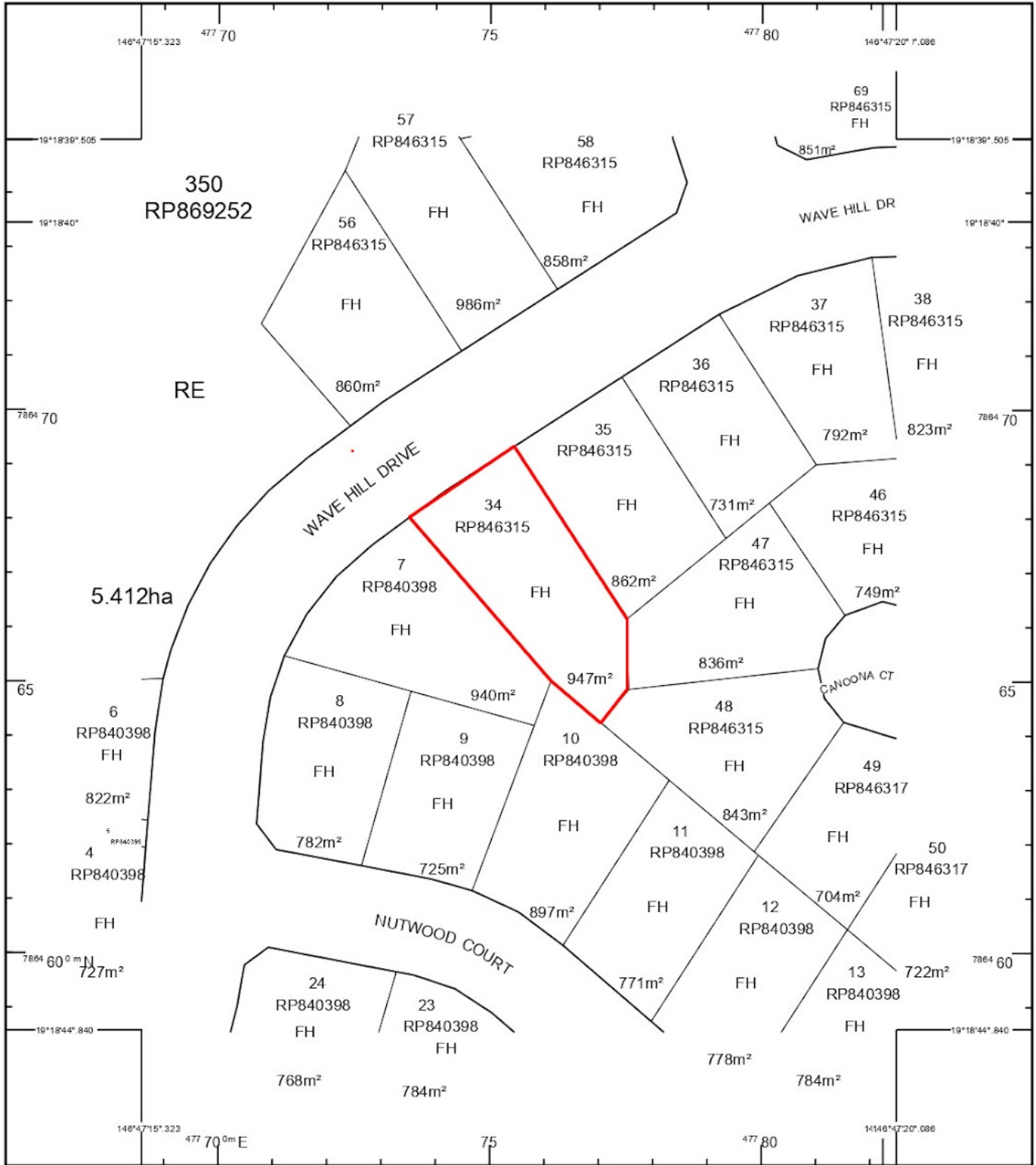

STANDARD MAP NUMBER
8259-24423



SmartMap

An External Product of
SmartMap Information Services

Based upon an extraction from the
Digital Cadastral Data Base

MAP WINDOW POSITION &
NEAREST LOCATION

146°47'15" 323
19°18'42" 172
ARMADALE
0.25 KM

SUBJECT PARCEL DESCRIPTION

DCDB
Lot/Plan 34/RP846315
Area/Volume 947m²

CLIENT SERVICE STANDARDS

PRINTED 28/04/2026

Disclaimer: Please note this floor plan is for marketing purposes and is to be used as a guide only. All dimensions are estimates only and may not be exact measurements.

Ken Triken
0419689498

kenentriken@atrealty.com.au
www.atrealty.com.au

Development best efforts, NRMMD makes no representations or warranties in relation to the information, and, to the extent permitted by law, exclude or limit all warranties relating to correctness, accuracy, reliability, completeness or currency and all liability for any direct, indirect and consequential costs, losses, damages and expenses incurred in any way (including but not limited to that arising from negligence) in connection with any use of or reliance on the information.
For further information on SmartMap products visit
<https://www.qld.gov.au/housing/buying-owning-home/property-land-valuations/smartmaps>

Queensland
Government

© The State of Queensland,
(Department of Natural Resources and Mines,
Manufacturing and Regional and Rural
Development) 026

@realty