



FOR SALE

SPACIOUS SINGLE LEVEL - STUNNING POOL

Perfectly positioned in a quiet cul-de-sac within one of Woongarra's most family-friendly locations, this spacious and beautifully presented residence offers the ideal blend of comfort, functionality and relaxed coastal living. Designed with growing families in mind, the home showcases multiple living zones, generous proportions and seamless indoor-outdoor entertaining.

From the moment you step inside, you're welcomed by light-filled interiors and a practical floorplan that effortlessly caters to both everyday living and entertaining. The heart of the home is the well-appointed kitchen, complete with quality appliances, ample bench space and excellent storage, all overlooking the main living and dining areas.

Flowing outdoors, the covered alfresco area creates the perfect setting for weekend BBQs, family gatherings or simply unwinding while watching the kids enjoy the backyard and pool area.

Located only moments from local schools, pristine beaches, shopping centres, parklands and easy access to the M1 motorway, this is a fantastic opportunity to secure a quality home in a highly sought-after location.

Features include:

- * Quiet cul-de-sac position in a family-friendly street
- * Multiple spacious living and dining areas
- * Functional kitchen with quality appliances and ample storage
- * Generous bedrooms with built-in wardrobes
- * Master suite featuring walk-in robe and ensuite
- * Covered outdoor entertaining area
- * Sparkling pool and low-maintenance backyard
- * Double garage with internal access
- * Close proximity to schools, shops, parks and motorway access

A superb opportunity for families, first home buyers or investors seeking lifestyle, convenience and space in a thriving location.

Disclaimer: While every effort has been made to ensure the accuracy of these particulars, no

4 BED | 2 BATH | 2 CAR

PRICE:
Contact Agent

OPEN FOR INSPECTION:
May 23 at 10:00am - 10:30am



Brendan James
0422851384
brendanjames@atrealty.com.au
www.atrealty.com.au

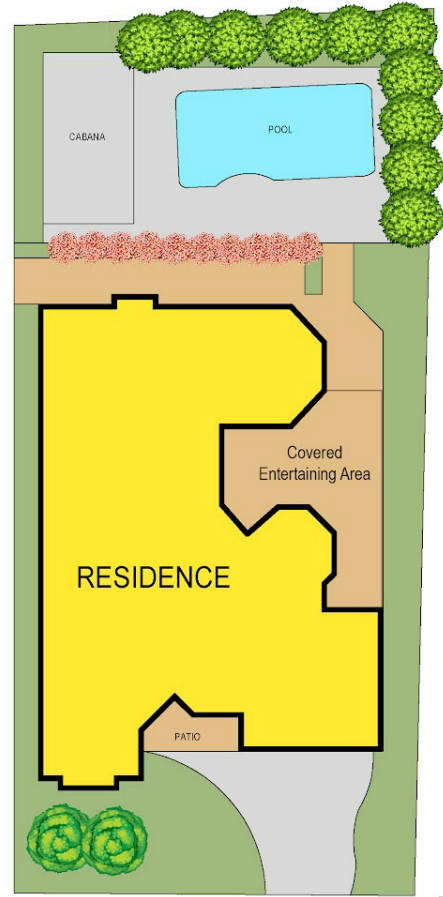
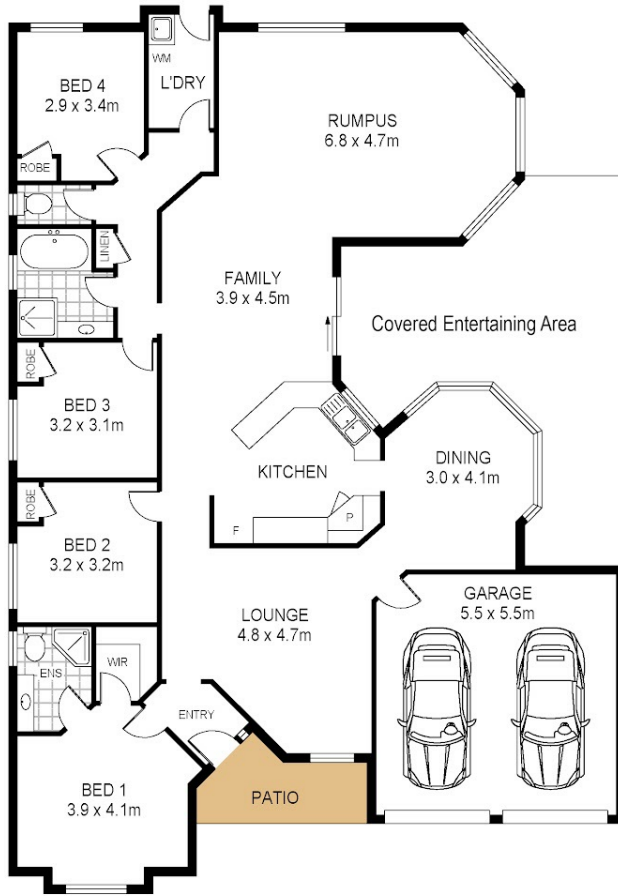

4 Primula Close
Woongarrah

Total Internal Floor Area: 212 sqm

Scale in metres indicative only. Dimensions are approximate. All information contained herein is gathered from sources we believe to be reliable. However we cannot guarantee its accuracy and interested persons should rely on their own enquiries



Disclaimer: Please note this floor plan is for marketing purposes and is to be used as a guide only. All dimensions are estimates only and may not be exact measurements.

