



Artist Impression Only



SOLD

NEW QUALITY HOME – COMPLETED SOON

Located within catchment areas of both desirable schools in Eastern suburbs - Beverley Hills Primary School and East Doncaster Secondary College, this near completed brand new home perfectly suits small families and astute investors who are looking for a solid asset to add to their portfolio.

Sophisticated & luxurious in every aspect, and full of natural light, this stunning townhouse showcases quality appointments, warm interiors and enviable low-maintenance appeal. Attributes downstairs include a bright lounge, open plan kitchen with 2 Pac cabinet finish, Caesar Stone bench top & quality stainless steel appliances, a study nook, powder room and a formal dining overlooking a sensational outdoor entertainment area. Upstairs includes 2 good sized bedrooms, 2 master ensuites and walk-in wardrobes, with all rooms equipped with reverse cycle air-conditioners.

Just a short stroll to Beverley Hills Primary School and transportation within close proximity to cafes, restaurants, parklands, easy access to Eastern Freeway & EastLink - just minutes to Westfield Shopping Town & Box Hill Central.

Contact Clive Chan (Doncaster East) 0449 181 969 for a private inspection.

2 BED | 2 BATH | 1 CAR

PRICE:
\$780,000

OPEN FOR INSPECTION:
N/A



Clive Chan
0449181969
clivechan@atrealty.com.au
www.atrealty.com.au

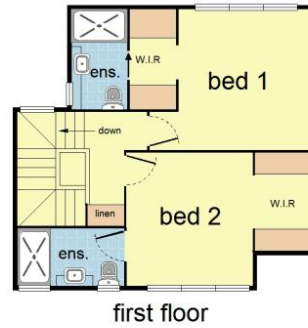

4/41 Rosella Street, Doncaster East

Disclaimer: Please note this floor plan is for marketing purposes and is to be used as a guide only. All dimensions are estimates only and may not be exact measurements.