

FOR SALE

BRIGHT FAMILY LIVING IN A CENTRAL HOPPERS CROSSING LOCATION

Positioned in a convenient pocket of Hoppers Crossing, this well-presented family home offers a bright and open layout, spacious living zones and a fantastic backyard for the whole family to enjoy. Ideal for first home buyers, growing families, investors and entertainers alike, the home provides comfortable living with plenty of space both inside and out.

At the heart of the home is a welcoming open-plan living, dining and kitchen area featuring warm floorboards, exposed brick arches and an abundance of natural light throughout. The kitchen has been updated with a brand new oven and dishwasher, creating a practical space for everyday living while overlooking the main living zone.

Comprising three bedrooms, the master bedroom includes a walk-in robe and ensuite, while the remaining bedrooms are fitted with built-in robes and serviced by a central bathroom. Additional features include ducted heating, wall-mounted air conditioning and a dedicated laundry.

Outside, the expansive backyard provides plenty of space for children to play, entertaining guests or simply enjoying the outdoors. The fully fenced yard is complemented by mature trees, a large carport and two storage sheds, creating a practical and enjoyable outdoor setting. With ample space on offer, the property also presents future subdivision potential, subject to council approval (STCA).

Positioned close to the highly sought-after Cambridge Primary School zone, this home enjoys close proximity to Pacific Werribee, the major bus interchange hub, Hoppers Crossing Secondary College, St Peter Apostle Primary School, Heathdale Christian College and Hogan's Corner Shopping Centre. Nearby parklands and recreational facilities further enhance the convenience and lifestyle appeal of this well-connected location.

3 BED | 2 BATH | 2 CAR

PRICE:
\$630,000 - \$670,000

OPEN FOR INSPECTION:
N/A



Samuel Hogan
0401315234
samuel@atrealty.com.au
www.atrealty.com.au

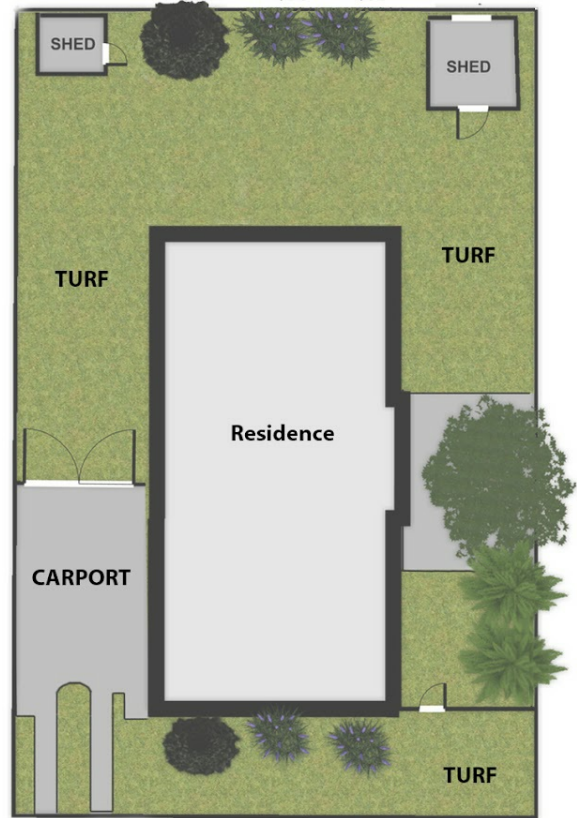

38 Wilkinson Street, Hoppers Crossing

Whilst every attempt has been made to ensure the accuracy of the floor plan contained here, measurements of doors, windows, rooms and any other items are approximate and no responsibility is taken for any error, omission, or mis-statement. This plan is for illustrative purposes only and should be used as such by any prospective purchaser. The services, systems and appliances shown have not been tested and no guarantee as to their operability or efficiency can be given.



Disclaimer: Please note this floor plan is for marketing purposes and is to be used as a guide only. All dimensions are estimates only and may not be exact measurements.