



FOR SALE

FIVE BEDROOMS, MULTIPLE LIVING AREAS & MINUTES TO EVERYTHING

COMING SOON | BOHLE PLAINS

Spacious Family Living in a Highly Convenient Location

A beautifully presented family home is about to hit the market in sought-after Bohle Plains.

Featuring multiple living zones, five bedrooms, two bathrooms, solar power and a fantastic outdoor entertaining area, this property offers the space and flexibility modern families are searching for.

Positioned on a low-maintenance block close to schools, shopping, parks and everyday conveniences, this is a home that combines comfort, practicality and lifestyle.

Currently undergoing final preparations and staging before launch.

For early information or to register your interest before the property goes live, contact Lara Rawson today.

Lara Rawson
Townsville @realty
0400 218 846

Disclaimer: While every effort has been made to ensure the accuracy of these particulars, no warranty is given by the vendor or the agent as to their accuracy. Interested parties should not rely on these particulars as representations of fact but must satisfy themselves by inspection or otherwise. Although high standards have been used in preparing this document, no legal responsibility can be accepted for any loss or damage resulting from the content or use of this information. Any photographs show only certain parts of the property as they appeared when taken. Areas, amounts, measurements, distances, and all other numerical information are approximate only. Note: Every care has been taken to verify the accuracy of the details in this advertisement; however, we cannot guarantee its correctness. Prospective purchasers are

5 BED | 2 BATH | 2 CAR

PRICE:

Offers Over \$929,000

OPEN FOR INSPECTION:

Jun 27 at 11:00am - 12:00pm



Lara Rawson
0400218846

lara@atrealty.com.au

www.townsvilleatrealty.com.au

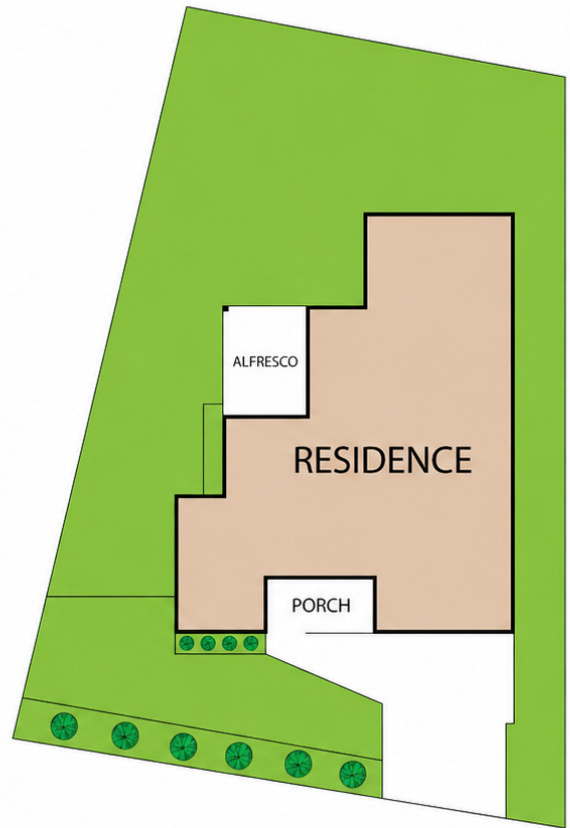
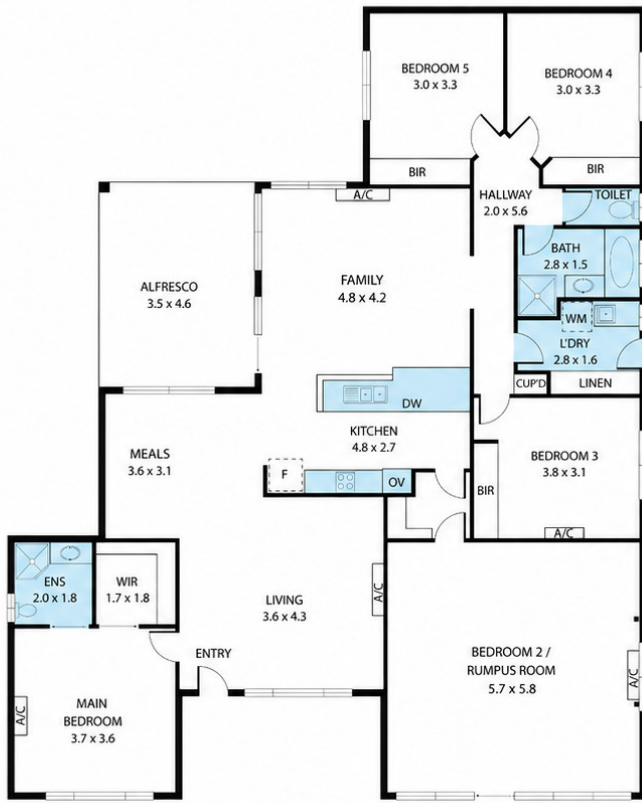

10 Kalynda Parade, Bohle Plains 4817

TOTAL APPROX. FLOOR AREA 188 SQ.M

Whilst every attempt has been made to ensure the accuracy of the floor plan contained here, measurements of doors, windows, rooms and any other items are approximate and no responsibility is taken for any error, omission, or misstatement. This plan is for illustrative purposes only and should be used as such by any prospective purchaser.



LIVING	:	172 SQ.M
ALFRESCO	:	16 SQ.M
TOTAL AREA	:	188 SQ.M

Disclaimer: Please note this floor plan is for marketing purposes and is to be used as a guide only. All dimensions are estimates only and may not be exact measurements.