



FOR SALE

MODERN PARKSIDE SANCTUARY IN BEAUTIFUL COUNTRY TOWN OF WARRAGUL.

Beautifully renovated and thoughtfully designed, this inviting two-bedroom residence delivers a refined blend of modern comfort and serene outdoor living, complete with direct access to expansive parklands.

Key Features...

Extensively renovated with crisp new paintwork and premium carpet throughout, the home presents with effortless style and comfort.

The sleek contemporary kitchen is appointed with new Bosch appliances, timber benchtops and quality tapware, creating a space that is both functional and beautifully finished. A bonus butler's pantry adds valuable preparation space and extra storage for everyday ease.

Two light-filled bedrooms offer built-in wardrobes and lovely garden outlooks, enhancing the home's calm and welcoming feel.

Designer-inspired updates, including new fixtures, a hot water service and split-system heating and cooling, bring a fresh, sophisticated feel throughout the home.

A cleverly integrated European laundry maximises the living space while maintaining a clean, streamlined layout.

Outdoor Living & Lifestyle...

A private courtyard provides the perfect setting for relaxed entertaining, alfresco dining, or simply unwinding in the open air.

With direct park access from the backyard, you can step straight into lush green surrounds and enjoy a rare sense of space and connection to nature. Beautiful walking paths, playgrounds and open green spaces create a peaceful environment to enjoy every day.

Positioned in a highly sought-after Warragul location, the home is just minutes from the train station, shops, cafés and popular farmers markets, offering exceptional convenience for everyday living.

2 BED | 1 BATH | 1 CAR

PRICE:

\$495,000 - \$510,000

OPEN FOR INSPECTION:

N/A



Mel Ahearn
0409183763

mahearn@atrealty.com.au

atrealtypropertysalesgippsland.com.au

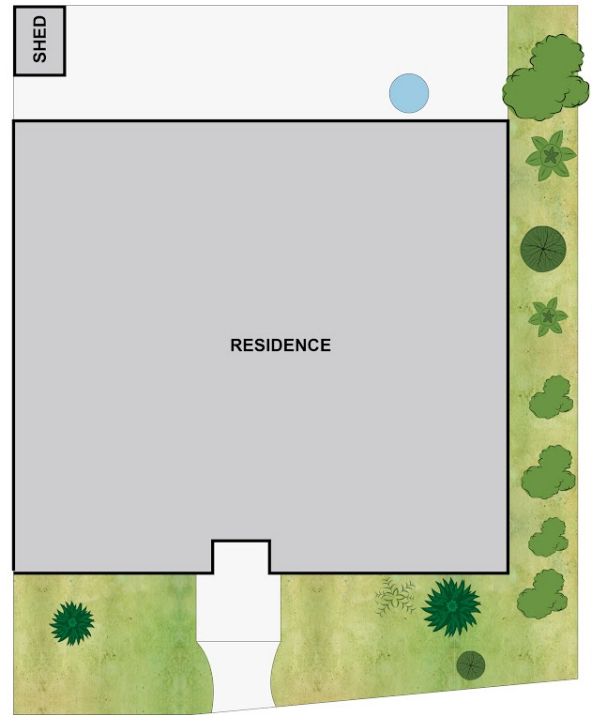
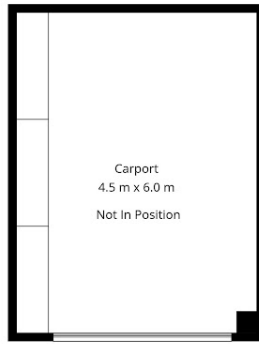

1/26 Toorak Avenue, Warragul

Whilst every attempt has been made to ensure the accuracy of the floorplan contained here all measurements are approximate and are for illustration purposes only. No responsibility is taken for any error, omission or misstatement

Disclaimer: Please note this floor plan is for marketing purposes and is to be used as a guide only. All dimensions are estimates only and may not be exact measurements.