



## FOR SALE

### A BACKYARD TO LOVE, A HOME TO MAKE YOUR OWN

Set on a beautiful, established section in the heart of Petone, this much-loved three-bedroom home offers comfort, character, and plenty of room to enjoy both inside and out.

The home features three bedrooms, separate living room, and a separate kitchen and dining area that creates a practical layout for family living. The spacious family bathroom incorporates the laundry, offering convenience for busy households. Thoughtful upgrades, including double glazing throughout and new curtains, add to the home's warmth and comfort, making it a welcoming place to enjoy in every season.

Step outside and you'll find a backyard that's becoming harder to find. Fully fenced and private, it's the perfect place for children and pets to play safely. Raised garden beds, mature fruit trees, and plenty of lawn space create a setting that's equally suited to weekend gardening, family gatherings, or simply relaxing in the sun with a coffee.

A single garage, carport and off-street parking add further convenience, while the generous section provides space to spread out and enjoy.

Comfortable as it is, there's also scope to add your own touches over time and make it truly yours. Homes with sections like this are becoming increasingly hard to find, making this a fantastic opportunity for families, first-home buyers, or anyone looking to enjoy a little more space both inside and out.

Warm, welcoming, and ready for its next owners to make their own memories, this is the kind of home that just feels right from the moment you arrive.

Deadline sale closing Thursday 23 July at 2pm (unless sold prior).

3 BED | 1 BATH | 2 CAR

**PRICE:**

Deadline sale. Deadline date  
23/07/2026

**OPEN FOR INSPECTION:**

Jul 12 at 1:00pm - 1:30pm



**Mike Lovell**

**0274356007**

[mike@luxerealty.co.nz](mailto:mike@luxerealty.co.nz)

[www.luxerealty.co.nz](http://www.luxerealty.co.nz)

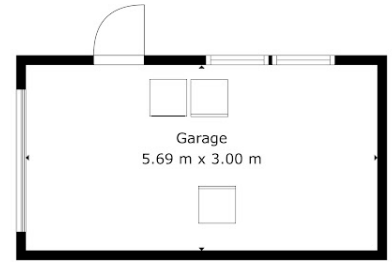
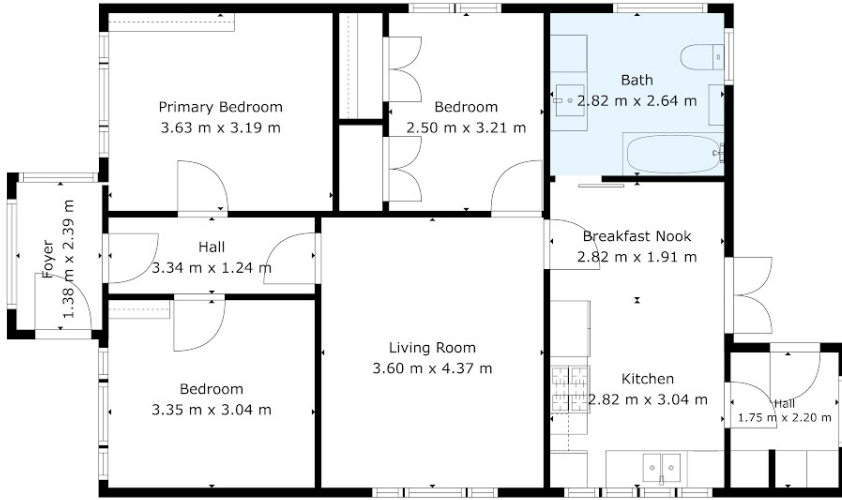

Measurements Are Indicative Only.



Disclaimer: Please note this floor plan is for marketing purposes and is to be used as a guide only. All dimensions are estimates only and may not be exact measurements.