

VIRTUALLY STAGE

FOR SALE

TOP FLOOR LIVING WITH STUNNING SEA VIEWS & YEAR ROUND SUNSETS

Positioned on the top floor of a well-maintained complex, this apartment offers an enviable lifestyle in one of Darwin's most sought-after coastal locations. With uninterrupted sunset views across the Arafura Sea, cooling sea breezes, and a spacious open plan design, this is an outstanding opportunity for owner-occupiers, first-home buyers, downsizers, or investors seeking a low-maintenance property in a premium setting.

Enjoy the convenience of having everything at your doorstep. Just a short stroll from the waterfront walking and cycling paths, popular cafés, restaurants, weekly markets, and local shopping centre with Woolworths, this central Coconut Grove address delivers the perfect balance of lifestyle and practicality. Darwin CBD, Royal Darwin Hospital, Charles Darwin University, and Darwin International Airport are all within easy reach.

Property Highlights

- 2 spacious bedrooms, including a main bedroom with extra-large built-in robes and private ensuite
- 2 bathrooms, including a combined bathroom and laundry
- Open plan living and dining area capturing ocean views and refreshing sea breezes
- Balcony with spectacular sunset and tropical storm views
- Modern kitchen with stainless steel appliances and dishwasher
- Split-system air conditioning throughout
- Tiled flooring throughout for easy maintenance
- New blinds installed throughout
- Private storage area adjacent to the unit
- Lift access within the complex
- Secure parking
- Approximately 2 minutes' walk to local shopping centre with Woolworths
- Approximately 5 minutes' walk to the waterfront walking and cycling paths, cafés, restaurants, nightlife, and weekly markets
- Less than 10 minutes to Darwin International Airport, Charles Darwin University, Royal Darwin Hospital, and Darwin CBD

2 BED | 2 BATH | 2 CAR

PRICE:
\$489,000

OPEN FOR INSPECTION:
N/A



Nicole Wheeler
0417508800
nicolewheeler@atrealty.com.au
www.atrealty.com.au

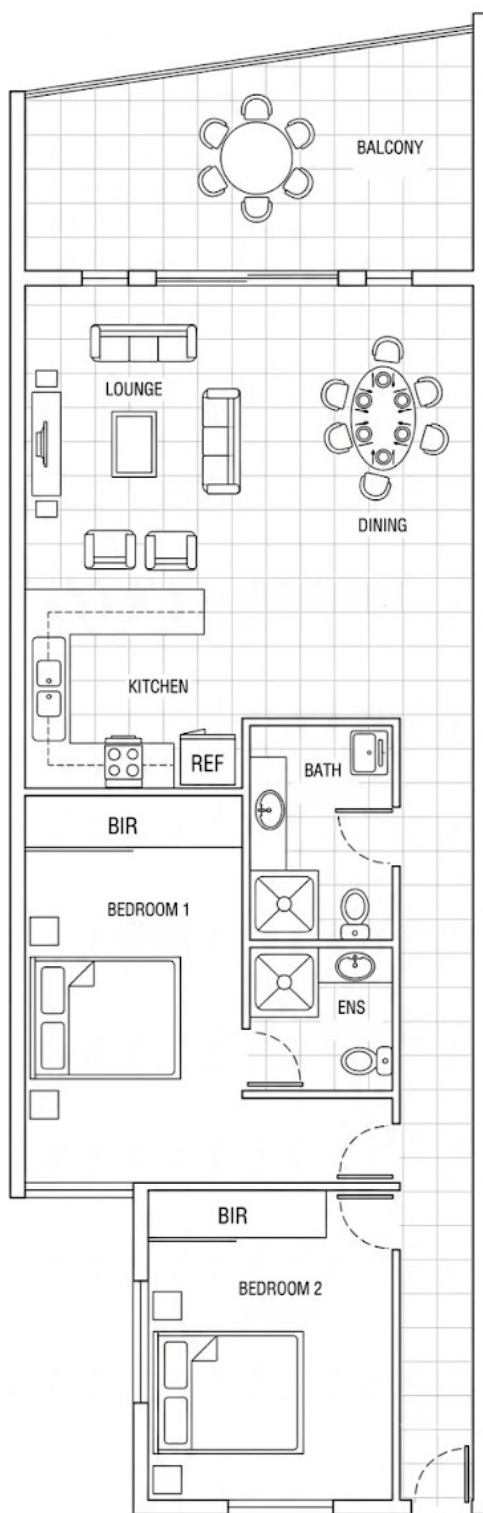

10/29 SUNSET DRIVE, COCONUT GROVE, NT 0810

Disclaimer: Please note this floor plan is for marketing purposes and is to be used as a guide only. All dimensions are estimates only and may not be exact measurements.