



FOR SALE

THE COMPLETE FAMILY OASIS

Welcome to 7 Burrows Place — a feature packed, architect designed Webb & Brown Neaves home set in a quiet, family friendly cul de sac. Fully renovated in 2017 with no expense spared, this is modern, move in ready living at its absolute best. Multiple living zones, a huge resort style alfresco & pool and a long list of high value upgrades make this one of Winthrop's most complete family homes. If you've been waiting for "the one"... this is it.

FEATURES INCLUDE

- 4 bedrooms + study, 2 bathrooms + two separate W/C
- Designed by Architect Allan McDonald, built by Webb & Brown Neaves
- Full 2017 renovation – premium & comprehensive, no shortcuts here!
- Quiet cul-de-sac location, elevated block
- Beautiful Jarrah flooring throughout, carpet to bedrooms
- Plantation shutters + sheers throughout
- Excellent separation between master & minor bedrooms
- Double garage with refurbished floor & shoppers' entrance
- Full security system with cameras + alarm
- GW 8.6kW solar system with 19.2kW battery + EV car charger
- Dual gas instantaneous hot water systems
- Daikin ducted r/v cycle air-conditioning
- Multiple gas bayonets throughout
- Extended WiFi
- Filtered bore system for filling the pool, save \$\$\$ per year
- Electric & solar heated pool
- Extra power points throughout
- Garden shed/powerd workshop
- Built 1990
- Council Rates: \$2,480 (25–26 FY)
- Water Rates: \$1,580.51 (24–25 FY)

KITCHEN

- High end V Zug appliances including 2 ovens, inbuilt microwave & induction cooktop
- Integrated Liebherr fridge & freezer
- Integrated Miele dishwasher
- Massive kitchen island bench

4 BED | 2 BATH | 2 CAR

PRICE:

NEW OPPORTUNITY - CALL FOR PRICE GUIDE

OPEN FOR INSPECTION:

Jul 4 at 12:30pm - 1:00pm

Jul 5 at 10:00am - 10:30am



Chloe Leggett | Jill Groves Team

0426618991

chloeleggett@atrealty.com.au

www.atrealty.com.au

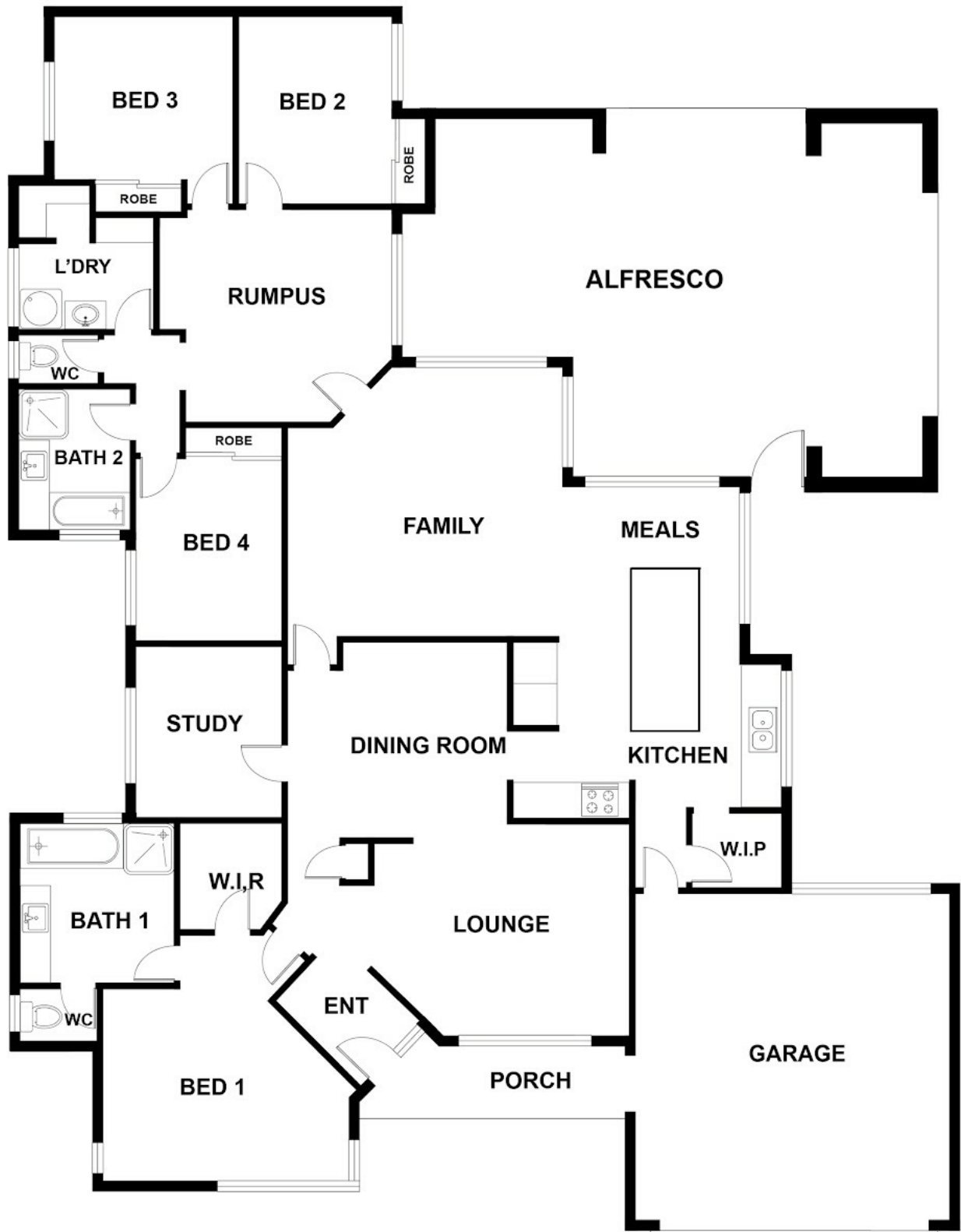

Disclaimer: Please note this floor plan is for marketing purposes and is to be used as a guide only. All dimensions are estimates only and may not be exact measurements.

@reality / Burrows Pl, Winthrop

Chloe Leggett | Jill Groves Team

0426618991

chloeleggett@atrealty.com.au

www.atrealty.com.au

Not to scale • All measurements are approximate • Drawn for presentation purposes only

@reality