



SOLD

BIGGER THAN SOME HOUSES

Contact your local Tricia 0457314206

A perfect opportunity awaits to purchase this very rare Strata unit. In a group of 2 with no strata fees, sit this beautiful 3 bedroom property. As you enter the home you will be blown away with the size. A very spacious lounge/ dine with a centrally located kitchen. The generous master bedroom with a wall of robes and a covenant 2 way bathroom is on offer. Bedrooms 2 and 3 are plenty big enough to accommodate Queen size beds if required. Under cover outdoor entertaining and very low maintenance gardens makes this ideal. Extras are a plenty with ducted cooling, gas heating, roller shutters, security system, 3 rain water tanks and a new roller door to the garage. Set on the high side of the road and surrounded by other quality homes. Positioned in a cul de sac and close to shops, transport and schools.

This is sure to go quickly

3 BED | 1 BATH | 1 CAR

PRICE:
\$290,000

OPEN FOR INSPECTION:
N/A



Tricia Kernahan
0457314206
tricia@atrealty.com.au
tfkrealstate.com.au
RLA: 269823

1, 15 Kerrin Avenue, Morphett Vale

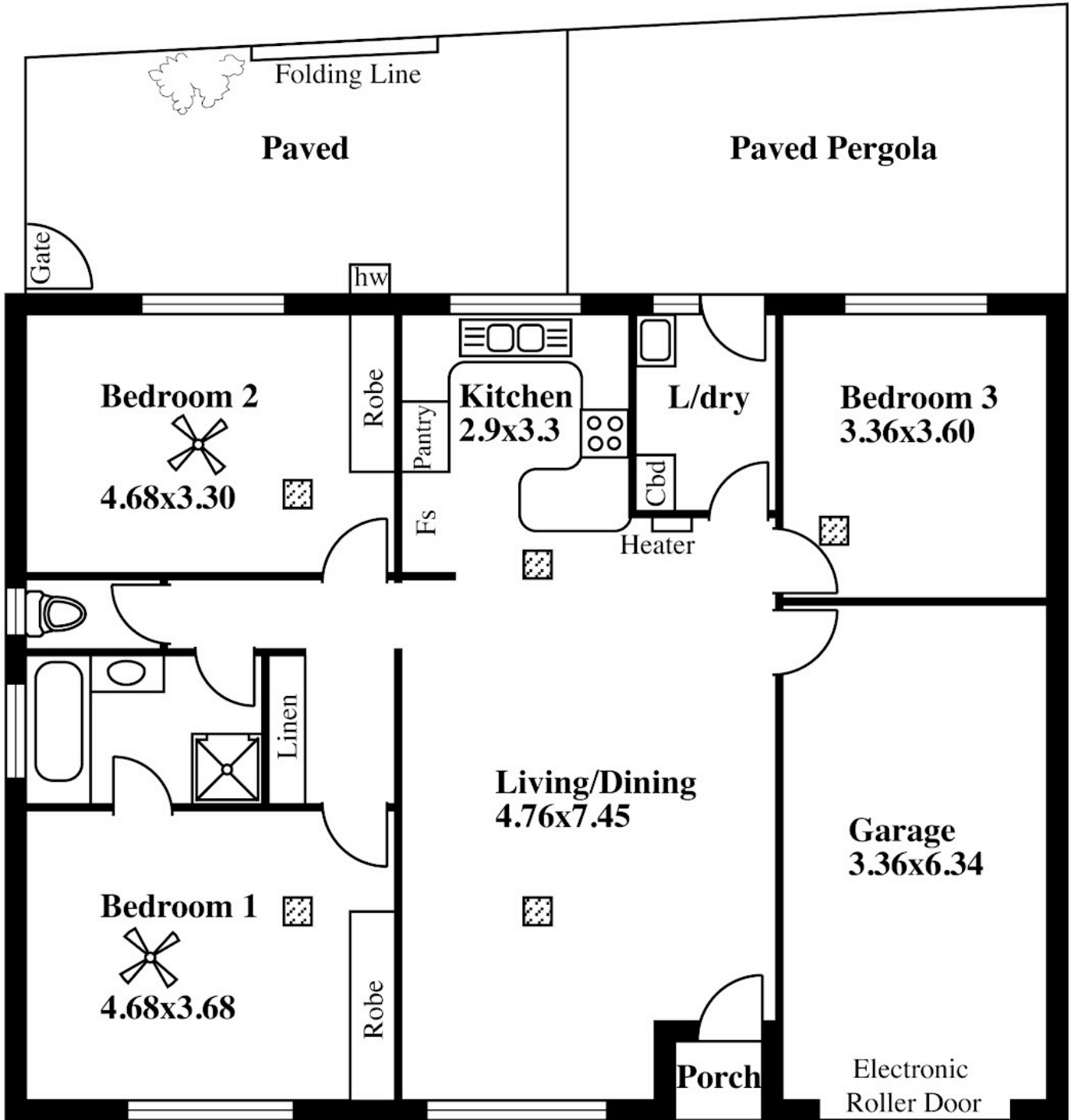

DISCLAIMER

This drawing is AN ARTISTS IMPRESSION ONLY
and for ILLUSTRATION PURPOSES ONLY.
(Drawing is not necessarily to scale)

ESTIMATE OF AREA

139.41 Square metres/ 14.98 Squares
(Including Garage)

Disclaimer: Please note this floor plan is for marketing purposes and is to be used as a guide only. All dimensions are estimates only and may not be exact measurements.

NOT intended to be part of any contract. All measurements are approximate and details intended to be relied upon should be independently verified.

Tricia Kerman
0457314206
tricia@atrealty.com.au
tfkrealestate.com.au

 Air cond ducts

Desk Top Image (V0312-14)
