



SOLD

NORTH FACING WATERFRONT HOME WITH DIRECT OCEAN ACCESS

This fully renovated beach house has everything you could want and more. Only a short paddle or boat ride to secluded beaches right from your garden. Located in an exclusive enclave overlooking leafy Koala Park with views to Burleigh Headland. Easy access to Burleigh Heads and Tallebudgera Beaches, trendy James Street shopping, restaurants and cafes. This waterfront home epitomises the perfect Burleigh Heads lifestyle and includes:

- *North to water with direct ocean access
- *Minutes to secluded beaches, bush walking tracks & National Parks
- *4 bedrooms, 3 bathrooms, main with ensuite & private sunlit deck with water views
- *4th bedroom has kitchenette - potential AirBnB
- *Living areas on both levels overlook pool and waterway
- *Modern chef's kitchen, Miele appliances, Ceaserstone benchtops, soft closing drawers, induction cooktop and built-in water filtering system
- *Triple garage
- *Inground pool, sauna, gym, outdoor showers
- *Wood burning fireplace, alarm system, air conditioning, ceiling fans, solar panels
- *Extremely private tranquil bush setting with waterside Bali hut

Surrounded by native wildlife in a lush tropical setting. Ideal home and location for the ultimate stand up paddle boarding, kayaking, boating and fishing lifestyle right in the heart of Burleigh Heads. 15mins drive to Airport.

4 BED | 2 BATH | 0 CAR

PRICE:
\$1,250,000

OPEN FOR INSPECTION:
N/A



Elizabeth Boccanfuso
0424589125
elizabeth@atrealty.com.au
www.atrealty.com.au

74 Ocean Parade BURLEIGH HEADS



4 Bedrooms | 3 Bathrooms | 3 Car
 Internal 224m² | External 97m² | Total 321m² or 35 Squares

Elizabeth Boccanfuso | 0424 589 125

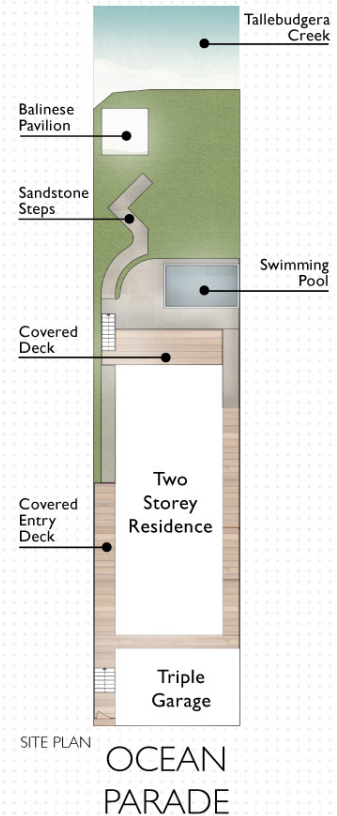
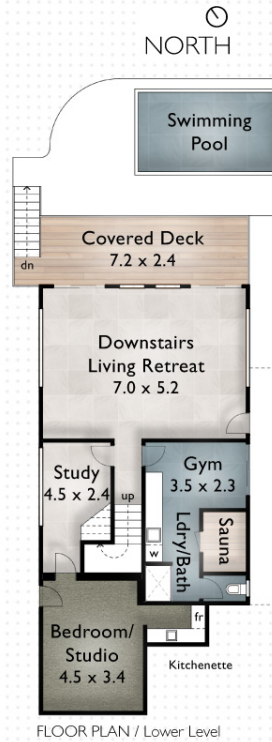

PURE DESIGN CONCEPTS
 Real Estate Marketing Floor Plans

Market Your Property Beautifully with puredesignconcepts.com.au

PURE DESIGN CONCEPTS ACCEPTS NO OWNERSHIP OR AUTHORSHIP OF THE ABOVE DESIGN. DRAWINGS ARE AN INTERPRETATION ONLY FOR THE BENEFIT OF MARKETING PURPOSES. ALL MEASUREMENTS ARE APPROXIMATE. INDIVIDUALS SHOULD RELY ON THEIR OWN INFORMATION.

Disclaimer: Please note this floor plan is for marketing purposes and is to be used as a guide only. All dimensions are estimates only and may not be exact measurements.

Elizabeth Boccanfuso
 0424589125
 elizabeth@atrealty.com.au
www.atrealty.com.au

